

DATASHEET - PKZM0-25

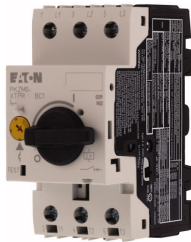

Motor-protective circuit-breaker, 12.5 kW, 20 - 25 A, Screw term



Powering Business Worldwide™

Part no. PKZM0-25
Catalog No. 046989
Alternate Catalog XTPR025BC1NL
No.
EL-Nummer 4355149
(Norway)

Delivery program

| | | | |
|----------------------|--|--|---|
| Product range | | | PKZM0 motor protective circuit-breakers up to 32 A |
| Basic function | | | Motor protection |
| | | | |
| Notes | | | Also suitable for motors with efficiency class IE3. |
| Connection technique | | | Screw terminals |
| Contact sequence | | | |

Max. motor rating

| | | | |
|-----------------------------|----------------|----|------|
| AC-3 | | | |
| 220 V 230 V 240 V | P | kW | 5.5 |
| 380 V 400 V 415 V | P | kW | 12.5 |
| 440 V | P | kW | 12.5 |
| 500 V | P | kW | 15 |
| 660 V 690 V | P | kW | 22 |
| Rated uninterrupted current | I _u | A | 25 |

Setting range

| | | | |
|--|-----------------|---|---|
| Overload releases | I _r | A | 20 - 25 |
| | | | |
| short-circuit release | | | |
| | | | |
| max. | I _{rm} | A | 388 |
| Phase-failure sensitivity | | | IEC/EN 60947-4-1, VDE 0660 Part 102 |
| Explosion protection (according to ATEX 94/9/EC) | | | PTB 10, ATEX 3013, Ex II(2) GD Observe manual MN03402003Z-DE/EN. |

NotesOverload trigger: tripping class 10 A
Can be snapped on to IEC/EN 60715 top-hat rail with 7.5 or 15 mm height.

Technical data

General

| | | | |
|---------------------|--|----|--|
| Standards | | | IEC/EN 60947, VDE 0660,UL, CSA |
| Climatic proofing | | | Damp heat, constant, to IEC 60068-2-78 Damp heat, cyclic, to IEC 60068-2-30 |
| Ambient temperature | | | |
| Storage | | °C | - 40 - 80 |
| Open | | °C | -25 - +55 |
| Enclosed | | °C | - 25 - 40 |

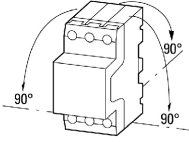
| | | | |
|---|---------------------------------|-------------------|---|
| Mounting position | | |  |
| Direction of incoming supply | | | as required |
| Degree of protection | | | |
| Device | | | IP20 |
| Terminations | | | IP00 |
| Protection against direct contact when actuated from front (EN 50274) | | | Finger and back-of-hand proof |
| Mechanical shock resistance half-sinusoidal shock 10 ms to IEC 60068-2-27 | g | | 25 |
| Altitude | m | | Max. 2000 |
| Terminal capacity main cable | | | |
| Screw terminals | | | |
| Solid | mm ² | | 1 x (1 - 6) 2 x (1 - 6) |
| Flexible with ferrule to DIN 46228 | mm ² | | 1 x (1 - 6) 2 x (1 - 6) |
| Solid or stranded | AWG | | 18 - 10 |
| Stripping length | mm | | 10 |
| Specified tightening torque for terminal screws | | | |
| Main cable | Nm | | 1.7 |
| Control circuit cables | Nm | | 1 |
| Main conducting paths | | | |
| Rated impulse withstand voltage | U _{imp} | V AC | 6000 |
| Overvoltage category/pollution degree | | | III/3 |
| Rated operational voltage | U _e | V AC | 690 |
| Rated uninterrupted current = rated operational current | I _u = I _b | A | 25 |
| Rated frequency | f | Hz | 40 - 60 |
| Current heat loss (3 pole at operating temperature) | | W | 7.04 |
| Impedance per pole | | mΩ | 4 |
| Lifespan, mechanical | Operations | x 10 ⁶ | 0.1 |
| Lifespan, electrical (AC-3 at 400 V) | | | |
| Lifespan, electrical | Operations | x 10 ⁶ | 0.1 |
| Max. operating frequency | | Ops/h | 40 |
| Short-circuit rating | | | |
| DC | | | |
| Short-circuit rating | kA | | 40 |
| Notes | | | up to 250 V |
| Motor switching capacity | | | |
| AC-3 (up to 690V) | A | | 25 |
| DC-5 (up to 250V) | A | | 25 (3 contacts in series) |
| Trip blocks | | | |
| Temperature compensation | | | |
| to IEC/EN 60947, VDE 0660 | °C | | - 5 ... 40 |
| Operating range | °C | | - 25 ... 55 |
| Temperature compensation residual error for T > 40 °C | | | ≅ 0.25 %/K |
| Setting range of overload releases | x I _u | | 0.6 - 1 |
| short-circuit release | | | Basic device, fixed: 15.5 x I |
| Short-circuit release tolerance | | | ± 20% |
| Phase-failure sensitivity | | | IEC/EN 60947-4-1, VDE 0660 Part 102 |
| Rating data for approved types | | | |
| Switching capacity | | | |
| Maximum motor rating | | | |
| Three-phase | | | |
| 230 V 240 V | HP | | 7.5 |

| | | |
|--|------|---------------|
| 460 V 480 V | HP | 15 |
| 575 V 600 V | HP | 20 |
| Single-phase | | |
| 115 V 120 V | HP | 2 |
| Short Circuit Current Rating, type E | SCCR | |
| 240 V | kA | 18 |
| 480 Y / 277 V | kA | 18 |
| Accessories required | | BK25/3-PKZ0-E |
| Short Circuit Current Rating, group protection | SCCR | |
| 600 V High Fault | | |
| SCCR (fuse) | kA | 10 |
| max. Fuse | A | 150 |
| SCCR (CB) | kA | 10 |
| max. CB | A | 125 |
| SCCR with CL (fuse) | A | 18 |
| max. Fuse (with CL) | A | 600 |
| SCCR with CL (CB) | kA | 18 |
| max. CB (with CL) | A | 600 |

Design verification as per IEC/EN 61439

| | | | |
|---|-------------------|----|--|
| Technical data for design verification | | | |
| Rated operational current for specified heat dissipation | I _n | A | 25 |
| Heat dissipation per pole, current-dependent | P _{vid} | W | 2.35 |
| Equipment heat dissipation, current-dependent | P _{vid} | W | 7.04 |
| Static heat dissipation, non-current-dependent | P _{vs} | W | 0 |
| Heat dissipation capacity | P _{diss} | W | 0 |
| Operating ambient temperature min. | | °C | -25 |
| Operating ambient temperature max. | | °C | 55 |
| IEC/EN 61439 design verification | | | |
| 10.2 Strength of materials and parts | | | |
| 10.2.2 Corrosion resistance | | | Meets the product standard's requirements. |
| 10.2.3.1 Verification of thermal stability of enclosures | | | Meets the product standard's requirements. |
| 10.2.3.2 Verification of resistance of insulating materials to normal h | | | Meets the product standard's requirements. |
| 10.2.3.3 Verification of resistance of insulating materials to abnormal and fire due to internal electric effects | | | Meets the product standard's requirements. |
| 10.2.4 Resistance to ultra-violet (UV) radiation | | | Meets the product standard's requirements. |
| 10.2.5 Lifting | | | Does not apply, since the entire switchgear needs to be evaluated. |
| 10.2.6 Mechanical impact | | | Does not apply, since the entire switchgear needs to be evaluated. |
| 10.2.7 Inscriptions | | | Meets the product standard's requirements. |
| 10.3 Degree of protection of ASSEMBLIES | | | Does not apply, since the entire switchgear needs to be evaluated. |
| 10.4 Clearances and creepage distances | | | Meets the product standard's requirements. |
| 10.5 Protection against electric shock | | | Does not apply, since the entire switchgear needs to be evaluated. |
| 10.6 Incorporation of switching devices and components | | | Does not apply, since the entire switchgear needs to be evaluated. |
| 10.7 Internal electrical circuits and connections | | | Is the panel builder's responsibility. |
| 10.8 Connections for external conductors | | | Is the panel builder's responsibility. |
| 10.9 Insulation properties | | | |
| 10.9.2 Power-frequency electric strength | | | Is the panel builder's responsibility. |
| 10.9.3 Impulse withstand voltage | | | Is the panel builder's responsibility. |
| 10.9.4 Testing of enclosures made of insulating material | | | Is the panel builder's responsibility. |
| 10.10 Temperature rise | | | The panel builder is responsible for the temperature rise calculation. Eaton will provide heat dissipation data for the devices. |
| 10.11 Short-circuit rating | | | Is the panel builder's responsibility. The specifications for the switchgear must be observed. |
| 10.12 Electromagnetic compatibility | | | Is the panel builder's responsibility. The specifications for the switchgear must be observed. |

| | | | |
|---------------------------|--|--|--|
| 10.13 Mechanical function | | | The device meets the requirements, provided the information in the instruction leaflet (IL) is observed. |
|---------------------------|--|--|--|

Technical data ETIM 8.0

Low-voltage industrial components (EG000017) / Motor protection circuit-breaker (EC000074)

Electric engineering, automation, process control engineering / Low-voltage switch technology / Circuit breaker (LV < 1 kV) / Motor protection circuit-breaker (ecl@ss10.0.1-27-37-04-01 [AGZ529016])

| | | |
|--|----|--|
| Overload release current setting | A | 20 - 25 |
| Adjustment range undelayed short-circuit release | A | 388 - 388 |
| With thermal protection | | No |
| Phase failure sensitive | | Yes |
| Switch off technique | | Thermomagnetic |
| Rated operating voltage | V | 690 - 690 |
| Rated permanent current Iu | A | 25 |
| Rated operation power at AC-3, 230 V | kW | 5.5 |
| Rated operation power at AC-3, 400 V | kW | 12.5 |
| Type of electrical connection of main circuit | | Screw connection |
| Type of control element | | Turn button |
| Device construction | | Built-in device fixed built-in technique |
| With integrated auxiliary switch | | No |
| With integrated under voltage release | | No |
| Number of poles | | 3 |
| Rated short-circuit breaking capacity Icu at 400 V, AC | kA | 50 |
| Degree of protection (IP) | | IP20 |
| Height | mm | 92.4 |
| Width | mm | 45 |
| Depth | mm | 75.2 |

Approvals

| | | |
|--------------------------------------|--|--|
| Product Standards | | IEC/EN 60947-4-1; UL 60947-4-1; CSA - C22.2 No. 60947-4-1-14; CE marking |
| UL File No. | | E36332 |
| UL Category Control No. | | NLRV |
| CSA File No. | | 165628 |
| CSA Class No. | | 3211-05 |
| North America Certification | | UL listed, CSA certified |
| Specially designed for North America | | No |
| Suitable for | | Branch circuit: Manual type E if used with terminal, or suitable for group installations |

Characteristics

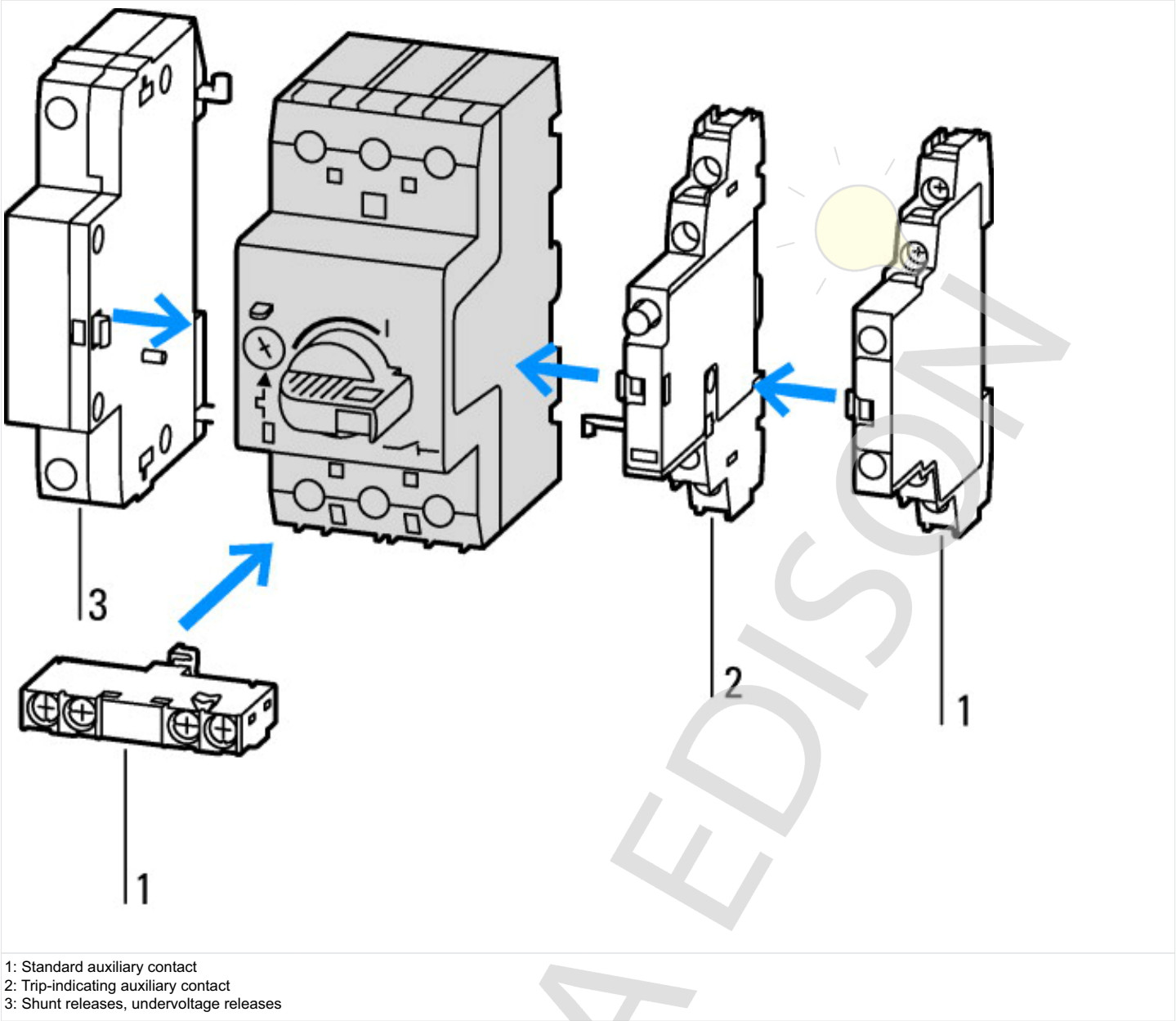

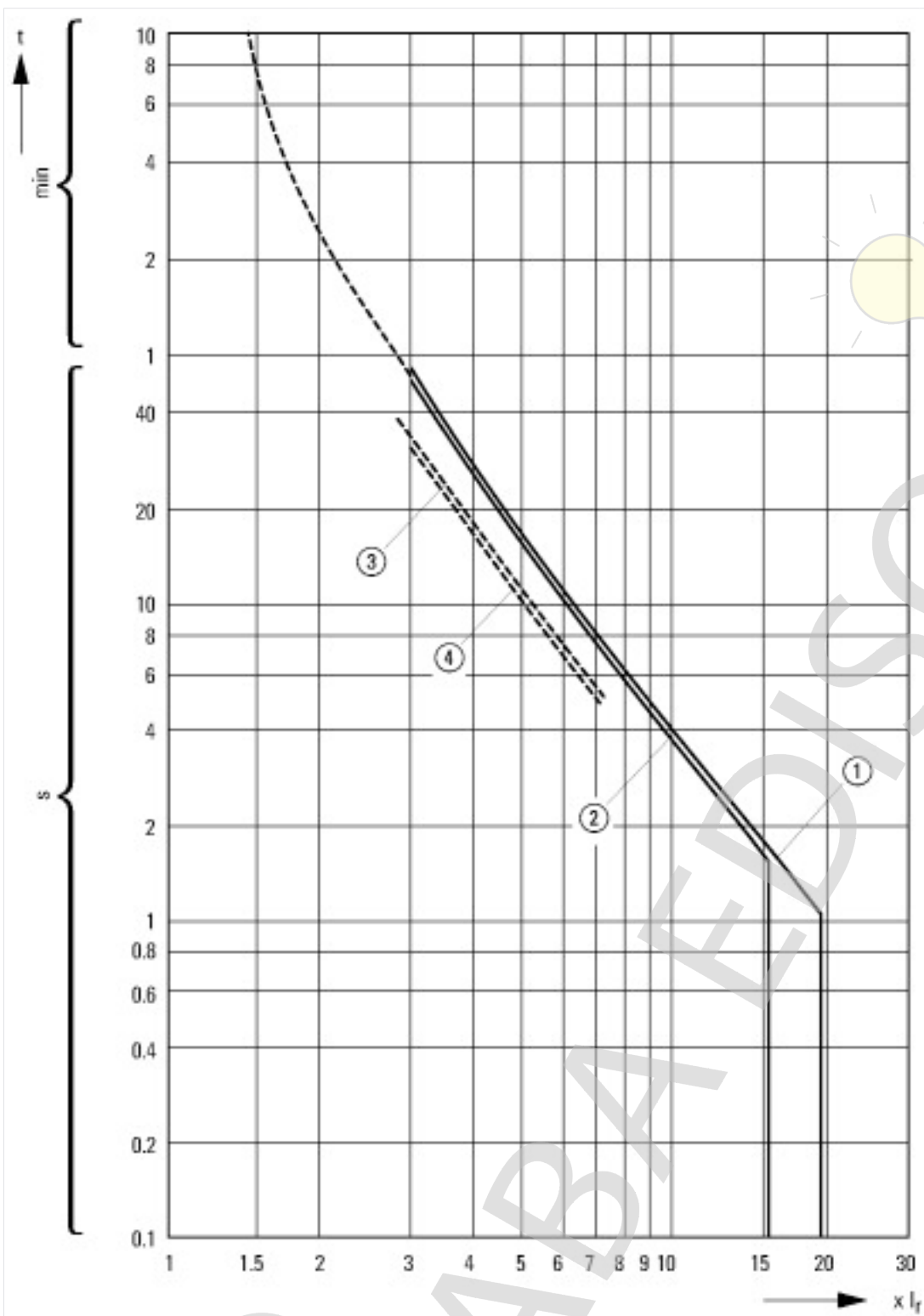

Tripping characteristics motor circuit breaker PKZM0-..., PKZM01

- 1: Minimum level, 3-phase
- 2: Maximum level, 3-phase
- 3: Minimum marker, 2-phase
- 4: Highest marker, 2-phase

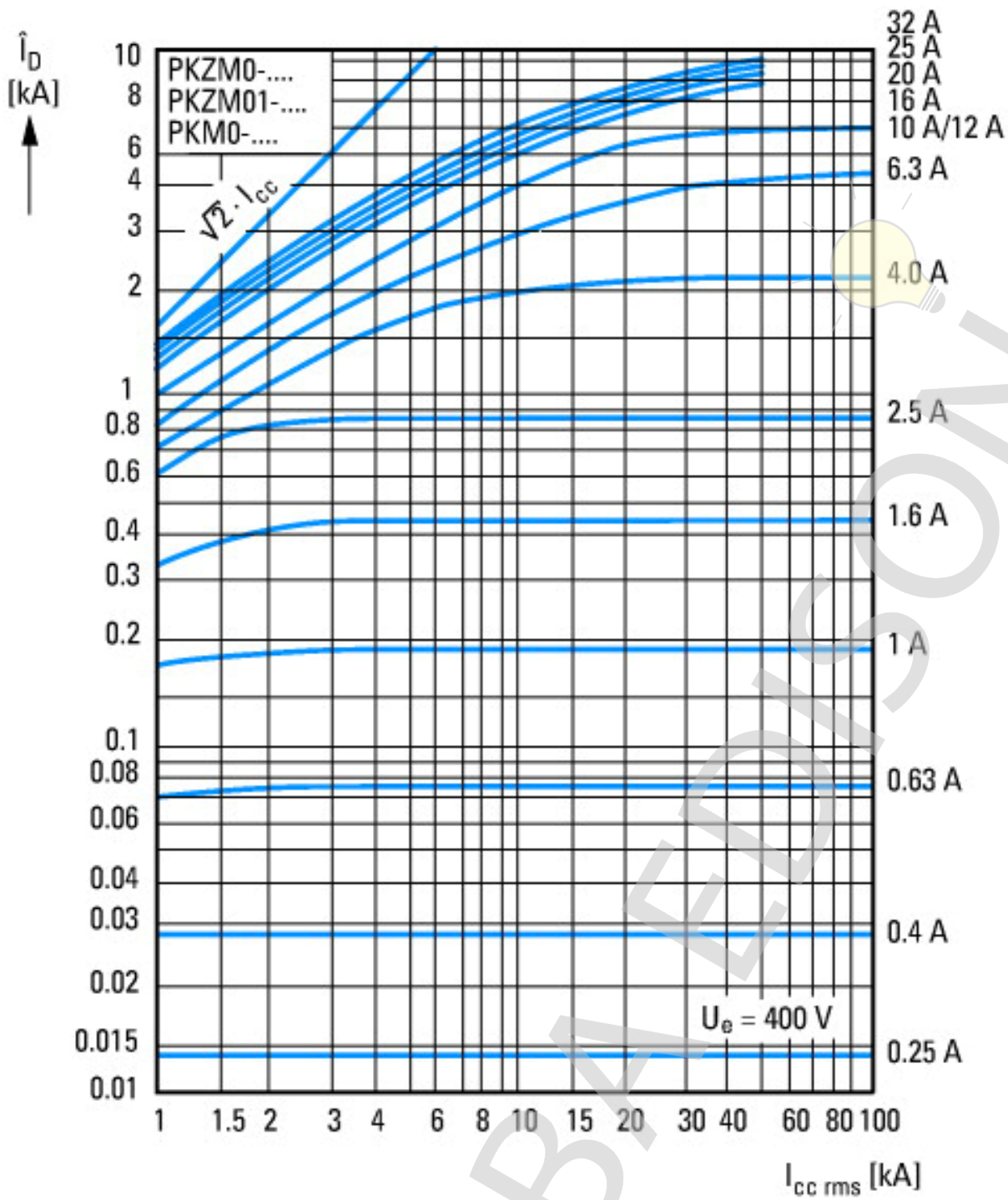

Let-through current

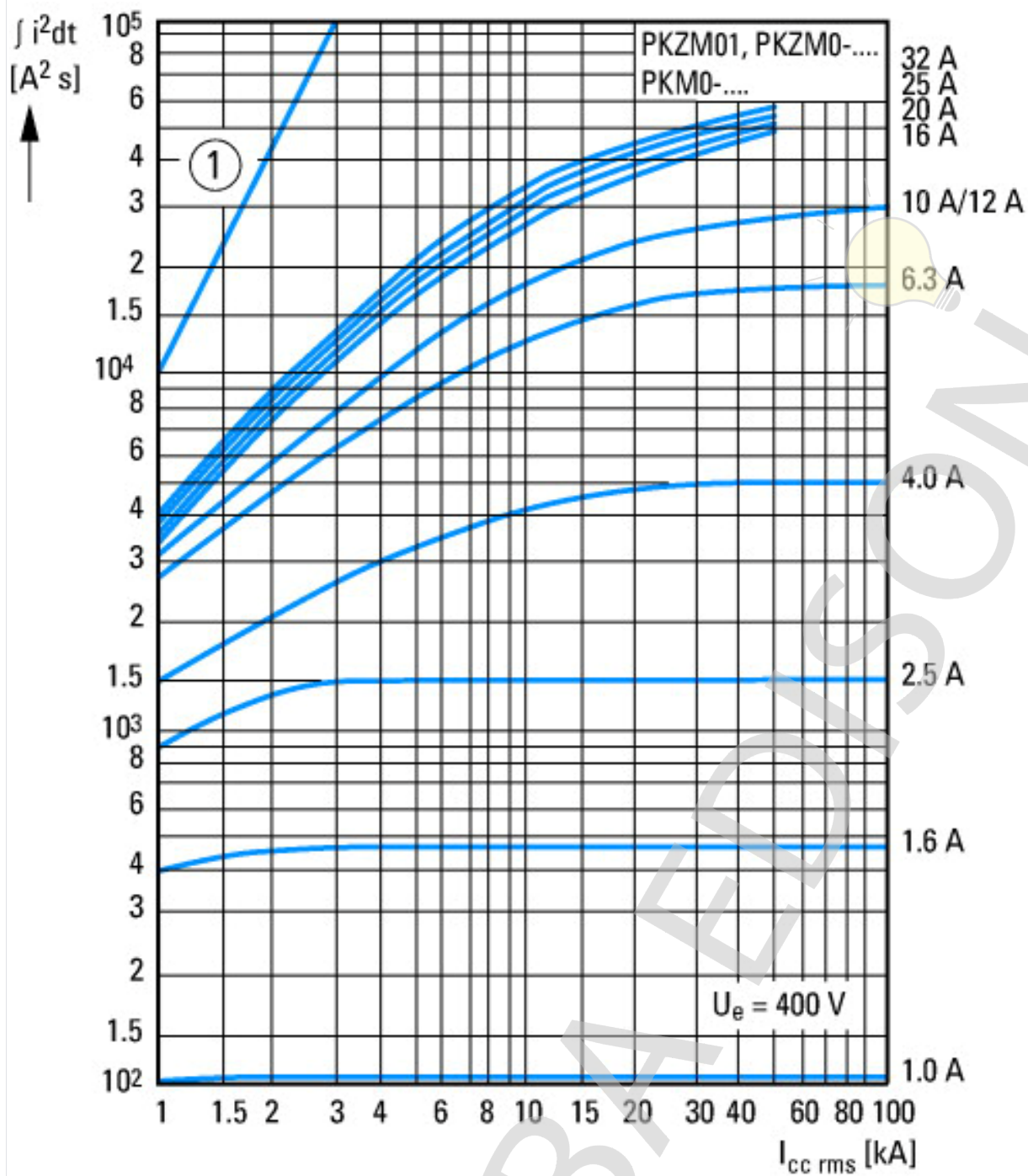

① 1 half-cycle
Let-through energy

Dimensions

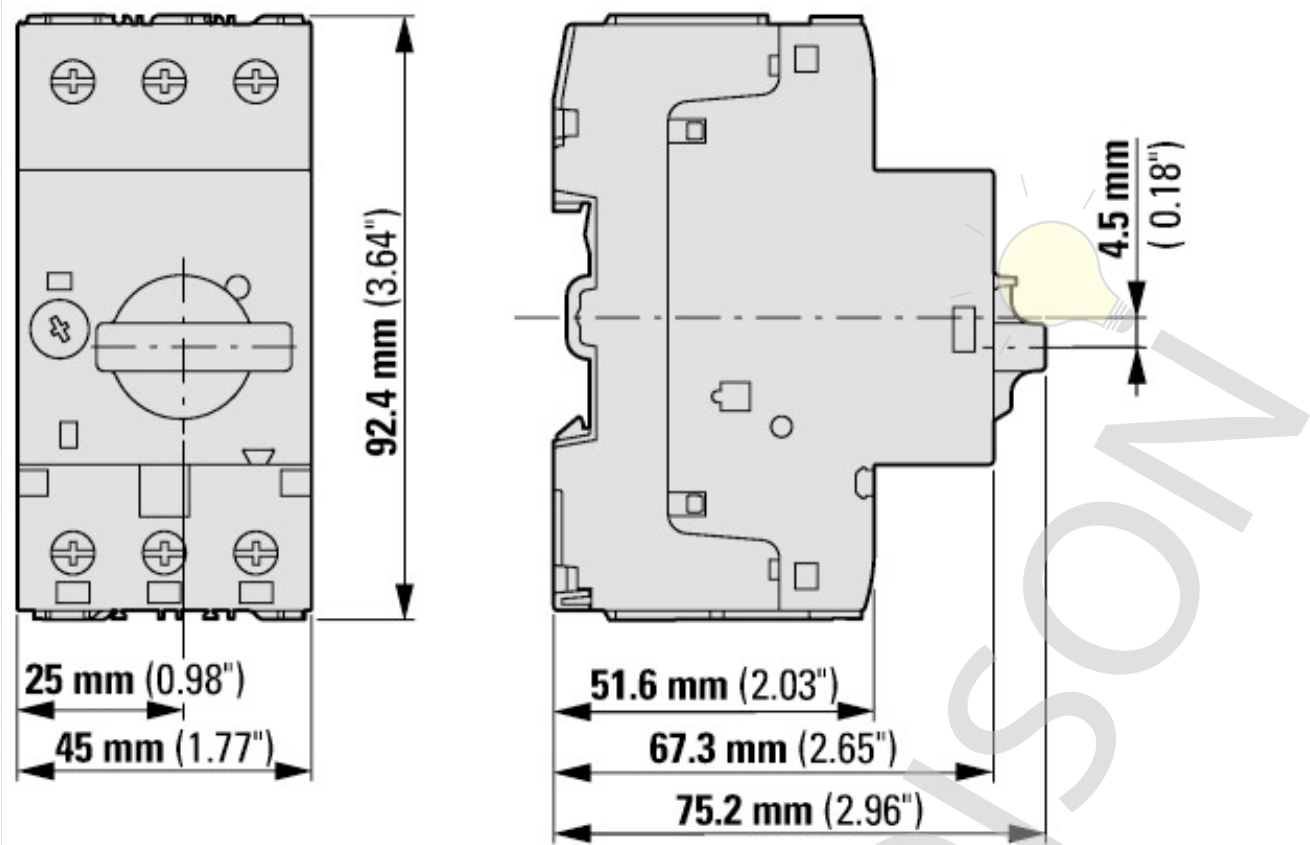

Motor-protective circuit-breaker with standard auxiliary contact
PKZM0-...(+NHI-E-...-PKZ0)
PKZM0-...-T(+NHI-E-...-PKZ0)
PKM0-...(+NHI-E-...-PKZ0)

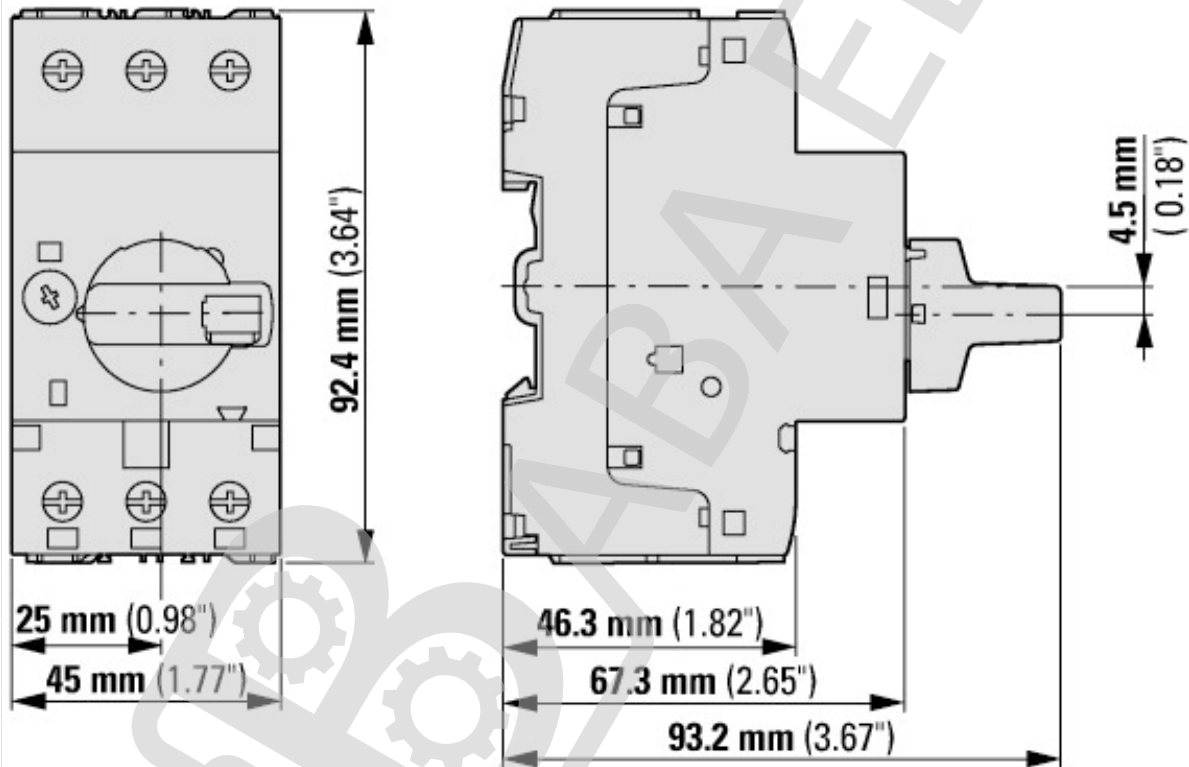

Motor-protective circuit-breakers with lockable rotary handles
PKZM0-...+AK-PKZ0

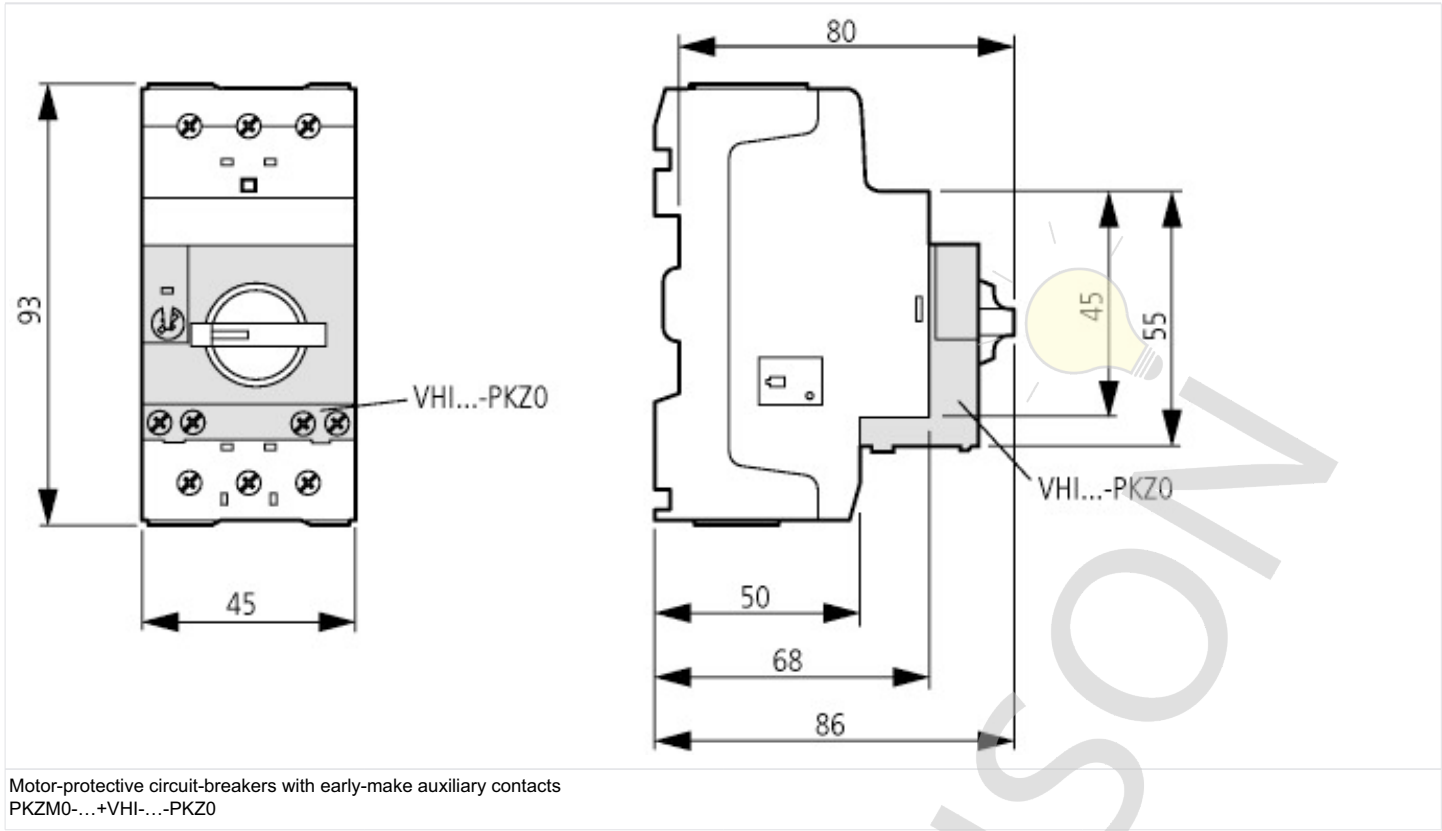

Additional product information (links)

| | |
|--|---|
| Schaltvermögen | https://de.ecat.eaton.com/flip-cat?edition=MOTCONT1_DE#page_3/44 |
| Motor starters and "Special Purpose Ratings" for the North American market | http://www.eaton.eu/ecm/groups/public/@pub/@europe/@electrical/documents/content/pct_3258146.pdf |
| Busbar Component Adapters for modern Industrial control panels | http://www.moeller.net/binary/ver_techpapers/ver960en.pdf |